



ATHLETICS CANADA

ROAD RACE MEASUREMENT CERTIFICATE

Race Information

Name of the course _____
Certificate number _____ Distance _____ Race date _____
City _____ Province _____
Race contact name _____ Race contact email _____

Course Information

Start elevation _____ Finish elevation _____
Elevation change _____ Percent separation _____

Measurer Information

Measurer name _____
Measurement date _____ Expiry date _____

Official Notice

Based on examination of data provided by the above named measurer, the course described above and in the map attached is hereby certified as reasonably accurate in measurement according to the standards adopted by the **Road Running Technical Council**. If any changes are made to the course, this certification becomes void, and the course must then be recertified.

Validation of Course

In the event a **National Open Record** is set on this course, or at the discretion of **Athletics Canada**, a validation remeasurement may be required to be performed by a qualified measurer. If such a remeasurement shows the course to be short, then all pending records will be rejected and the course certification will be cancelled.

As Nationally Certified by

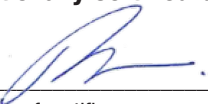

Signature of certifier

Paul T.B. Adams

Date

Any inquires regarding this certificate should be directed to coursemeasurement@athletics.ca



Athletics Canada Certified
BC-2026-001-PTBA
 Certification Expires 2036-12-31
 Map page 1 of 2



Rocky Point Race



Burrard Inlet

- Notes:
- The course starts and finishes in Rocky Point Park and runs along Murray St. in the dedicated bike lanes/sidewalk as well as the Shoreline Multi-Use Trail.
 - The course was measured across the sidewalks and bike paths using the shortest possible tangents, while adhering to the 30 cm curbside rule
 - The path must be divided by cones from 'Point A' on the map to the Turnaround.
 - The certification is not valid if the course is not set out in accordance with this map.
 - Map and detail areas not drawn to scale.
 - Measured by Geoffrey Buttner, Grade B Measurer.

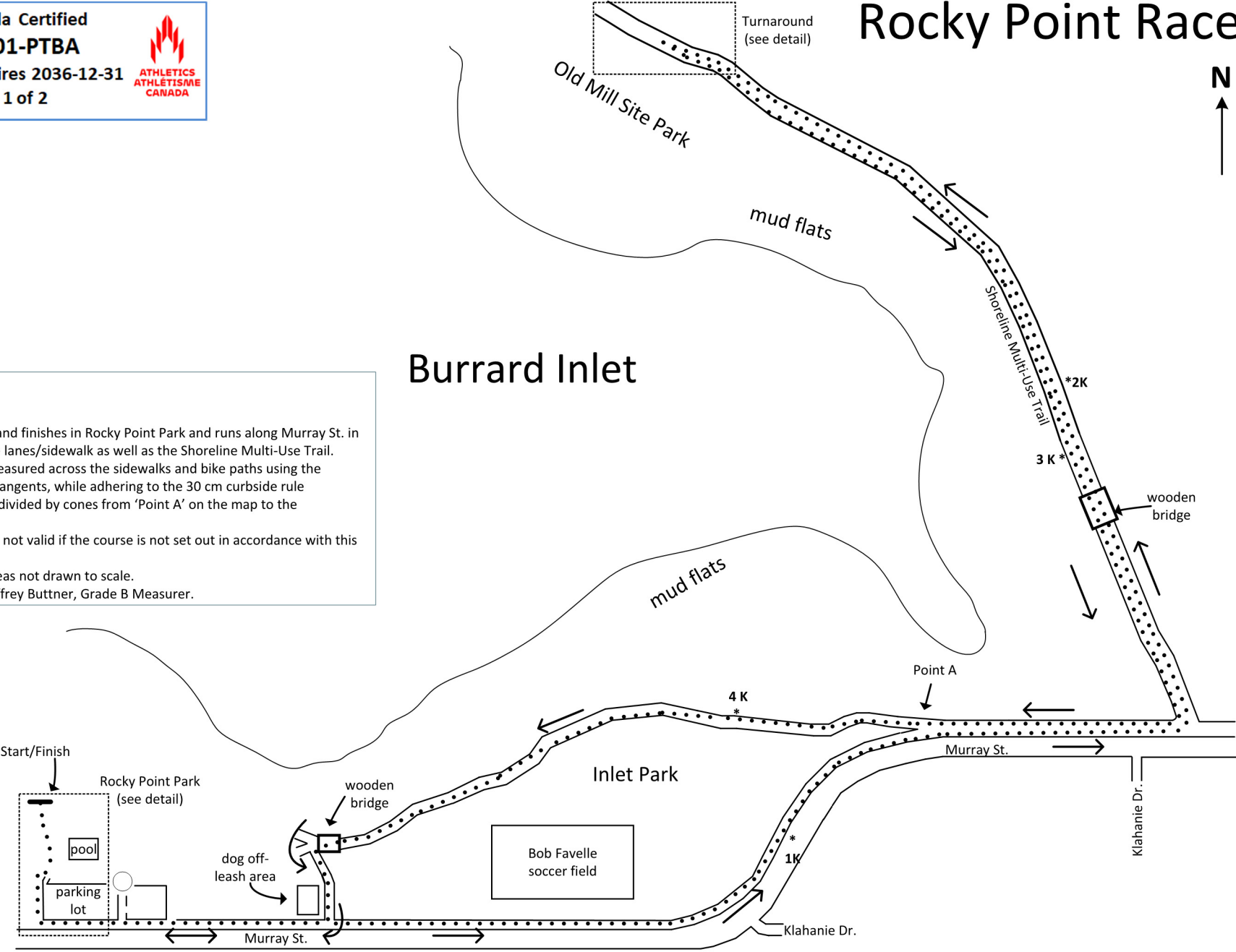

Start/Finish Detail

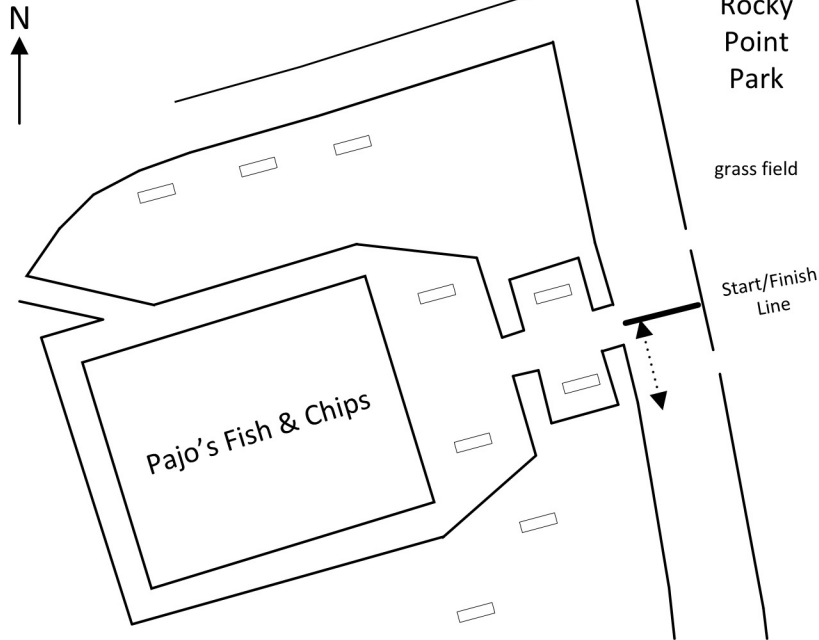

The Start/Finish Line is on the westernmost north/south footpath in Rocky Point Park. It is at the center point of the sidewalks Both coming from Pajo's Fish & Chips and the north/south footpath. Runners start heading south and finish coming back to the north.

The turnaround point is to be placed in the middle of the path, 19 meters south of the north edge of the concrete foundation under the bench; this is the first bench located along the path's east side north of the 2K mark.

Turnaround detail

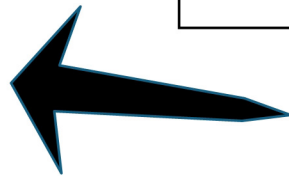
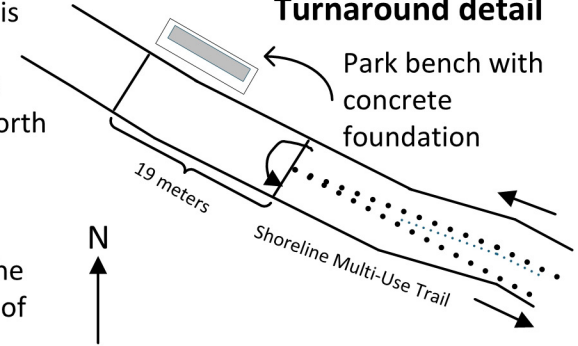

Rocky Point Park Detail

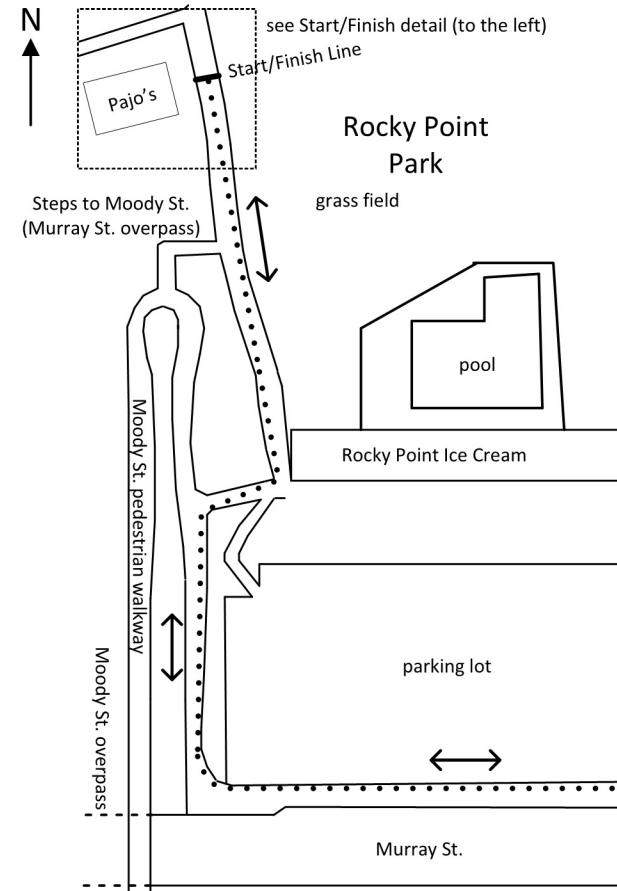

Athletics Canada Certified

BC-2026-001-PTBA

Certification Expires 2036-12-31

Map page 2 of 2

