



ATHLETICS CANADA

ROAD RACE MEASUREMENT CERTIFICATE

Race Information

Name of the course _____
Certificate number _____ Distance _____ Race date _____
City _____ Province _____
Race contact name _____ Race contact email _____

Course Information

Start elevation _____ Finish elevation _____
Elevation change _____ Percent separation _____

Measurer Information

Measurer name _____
Measurement date _____ Expiry date _____

Official Notice

Based on examination of data provided by the above named measurer, the course described above and in the map attached is hereby certified as reasonably accurate in measurement according to the standards adopted by the **Road Running Technical Council**. If any changes are made to the course, this certification becomes void, and the course must then be recertified.

Validation of Course

In the event a **National Open Record** is set on this course, or at the discretion of **Athletics Canada**, a validation remeasurement may be required to be performed by a qualified measurer. If such a remeasurement shows the course to be short, then all pending records will be rejected and the course certification will be cancelled.

As Nationally Certified by

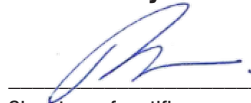
 Paul T.B. Adams

Signature of certifier _____ Date _____

Any inquires regarding this certificate should be directed to coursemeasurement@athletics.ca



The Runway 2 Mile Run & 5 Mile Run
 Region of Waterloo International Airport
 Breslan, Ontario

2 Mile
 Start/Finish
 &
 5 Mile Finish

- 21.2m W of 4th Runway Light
- Between 3rd + 4th Runway Lights East of Cut through from Taxi way to Runway
- 781.1100m West of Point ①

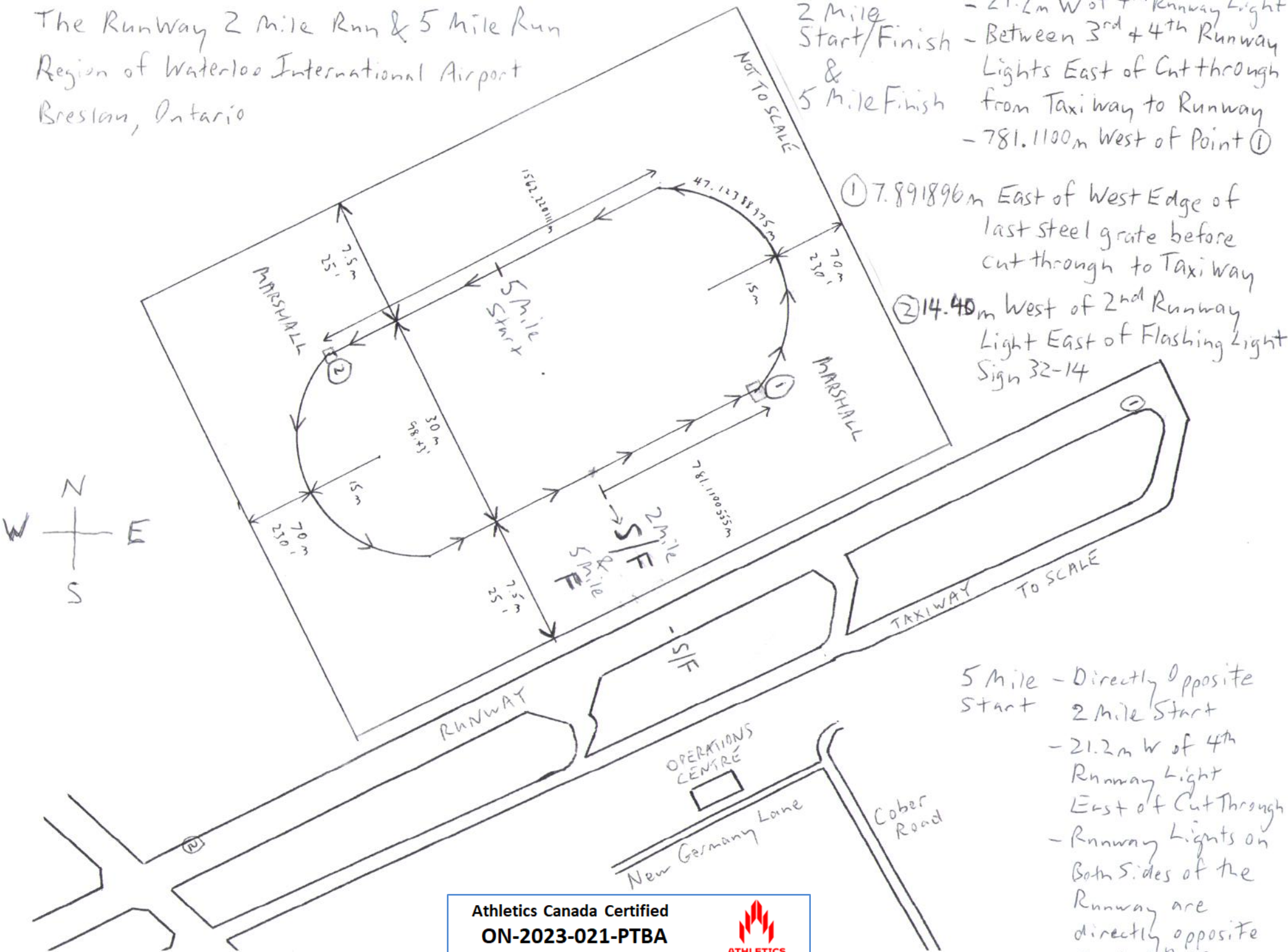

- ① 7.891896m East of West Edge of last steel grate before cut through to Taxi way
- ② 14.40m West of 2nd Runway Light East of Flashing Light Sign 32-14

- 5 Mile - Directly Opposite 2 Mile Start
- 21.2m W of 4th Runway Light East of Cut Through
- Runway Lights on Both Sides of the Runway are directly opposite each other.