



ATHLETICS CANADA

ROAD RACE MEASUREMENT CERTIFICATE

Race Information

Name of the course _____

Certificate number _____ Distance _____ Race date _____

City _____ Province _____

Race contact name _____ Race contact email _____

Course Information

Start elevation _____ Finish elevation _____

Elevation change (m/km) _____ Percent separation _____

Measurer Information

Measurer name _____

Measurement date _____ Expiry date _____

Official Notice

Based on examination of data provided by the above named measurer, the course described above and in the map attached is hereby certified as reasonably accurate in measurement according to the standards adopted by the **Road Running Technical Council**. If any changes are made to the course which results in a course that is less than the stated distance, this certification becomes void, and the course must then be re-certified.

Validation of Course

In the event a **National Open Record** is set on this course, or at the discretion of **Athletics Canada**, a validation remeasurement may be required to be performed by a qualified measurer. If such a remeasurement shows the course to be short, then all pending records will be rejected and the course certification will be cancelled.

As Nationally Certified by

Signature of certifier

Date

Any inquires regarding this certificate should be directed to coursemeasurement@athletics.ca



Route 105 Woodstock, NB 300 m Calibration Course

Measured May 27, 2023
 by Andrew Ottens &
 Bruce Macfarlane
 Located in Woodstock
 New Brunswick



Athletics Canada Certified
 NB-2023-013-BDC

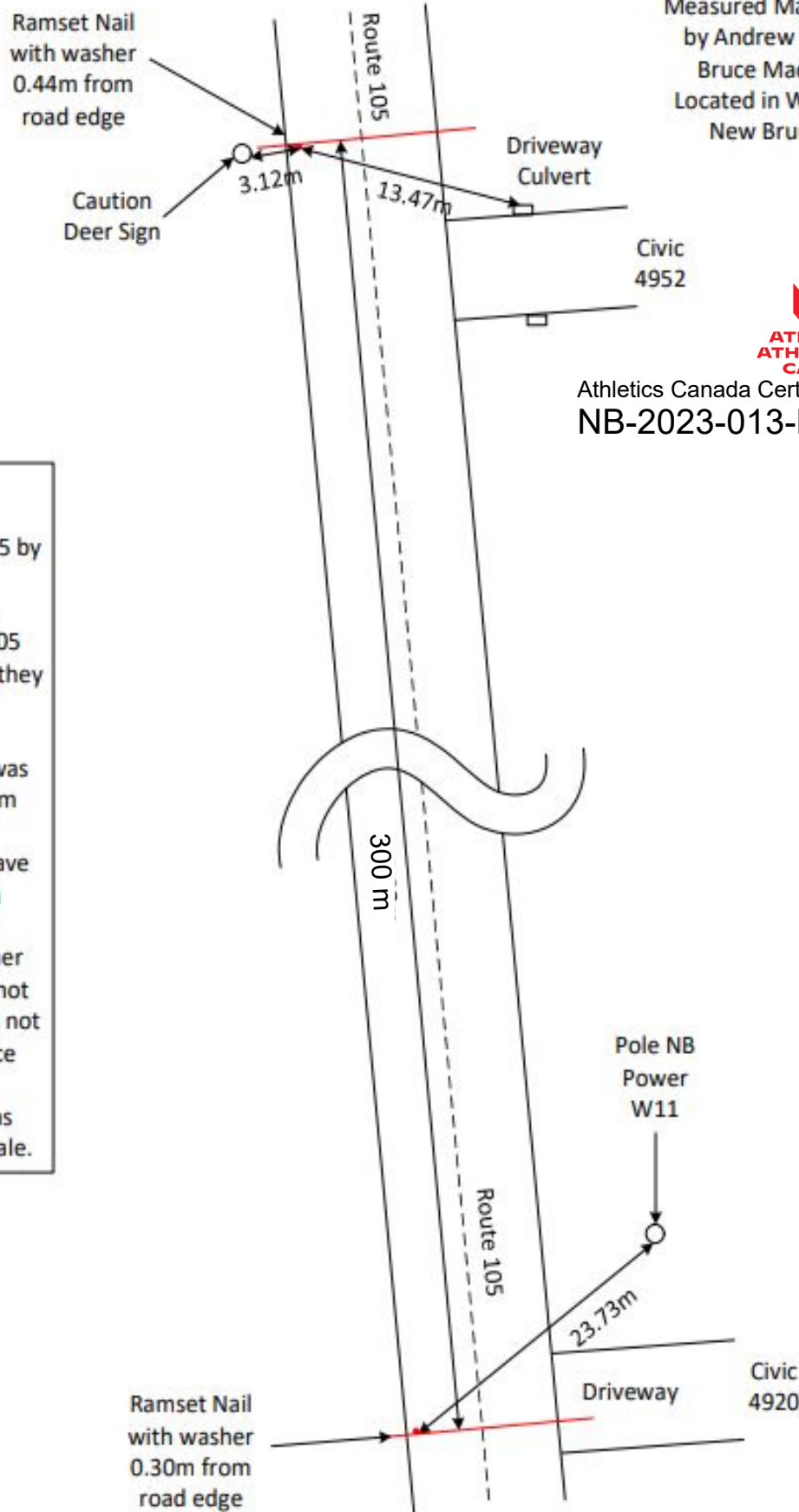

Course Notes

- Start is on Route 105 by Ultramar Station (Elevation of 49m), Finish is on Route 105 (Elevation of 49m), they are separated by 300.00m.
- Calibration course was measured 30cm from right edge of road
- Both course ends have been marked with a Ramset nail and a Stainless Steel washer
- This certification is not valid if the course is not set out in accordance with this map.
- Map and detail areas are not drawn to scale.