



# ATHLETICS CANADA

## ROAD RACE MEASUREMENT CERTIFICATE

### Race Information

Name of the course \_\_\_\_\_  
Certificate number \_\_\_\_\_ Distance \_\_\_\_\_ Race date \_\_\_\_\_  
City \_\_\_\_\_ Province \_\_\_\_\_  
Race contact name \_\_\_\_\_ Race contact email \_\_\_\_\_

### Course Information

Start elevation \_\_\_\_\_ Finish elevation \_\_\_\_\_  
Elevation change \_\_\_\_\_ Percent separation \_\_\_\_\_

### Measurer Information

Measurer name \_\_\_\_\_  
Measurement date \_\_\_\_\_ Expiry date \_\_\_\_\_

### Official Notice

Based on examination of data provided by the above named measurer, the course described above and in the map attached is hereby certified as reasonably accurate in measurement according to the standards adopted by the **Road Running Technical Council**. If any changes are made to the course, this certification becomes void, and the course must then be recertified.

### Validation of Course

In the event a **National Open Record** is set on this course, or at the discretion of **Athletics Canada**, a validation remeasurement may be required to be performed by a qualified measurer. If such a remeasurement shows the course to be short, then all pending records will be rejected and the course certification will be cancelled.

### As Nationally Certified by

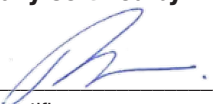
 Paul T.B. Adams  
\_\_\_\_\_  
Signature of certifier \_\_\_\_\_ Date \_\_\_\_\_

Any inquiries regarding this certificate should be directed to [coursemeasurement@athletics.ca](mailto:coursemeasurement@athletics.ca)



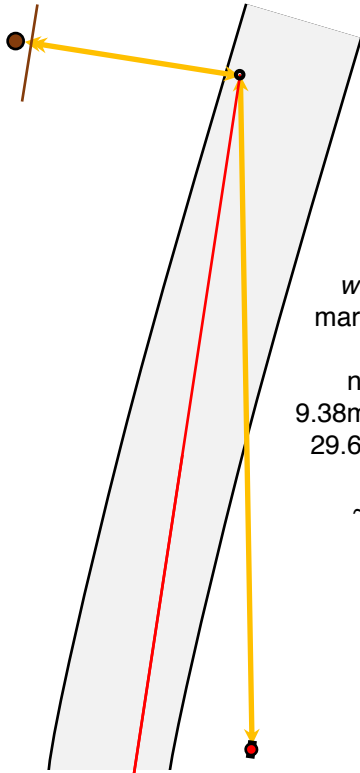

~103m from N end of Dixon Rd;  
and ~20m N of streamlet;

### North Endpoint

where Dixon Rd bends and dips;  
marked with nail & cap near W edge;  
aligned with utility pole on W  
near N edge of #2424 property;  
9.38m to fence 0.25m before utility pole;  
29.67m to fire hydrant on E ~29.3m S  
opposite driveway to #2424;  
~ 48.39835°N & 123.69595°W

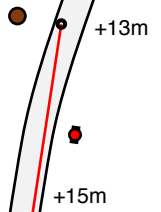

## Dixon Road 300.000m Calibration

### Sooke BC

Measured: 2022 January 29<sup>th</sup>  
by Gary Duncan  
with Kathleen Quast & Sandy Gibson  
Altitude: Ends: +13m High: +15m

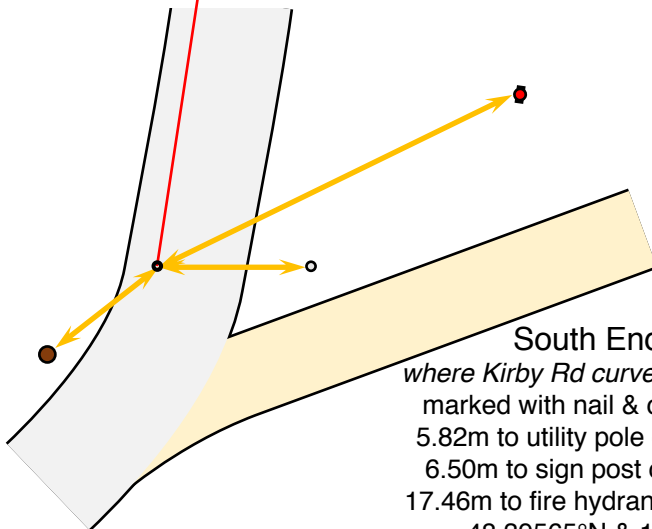
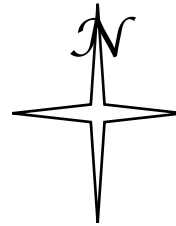

### South Endpoint

where Kirby Rd curves into Dixon Rd;  
marked with nail & cap on W side;  
5.82m to utility pole on W ~4.2m S;  
6.50m to sign post on E ~0.9m N;  
17.46m to fire hydrant on E ~9.7m N;  
~ 48.39565°N & 123.69665°W

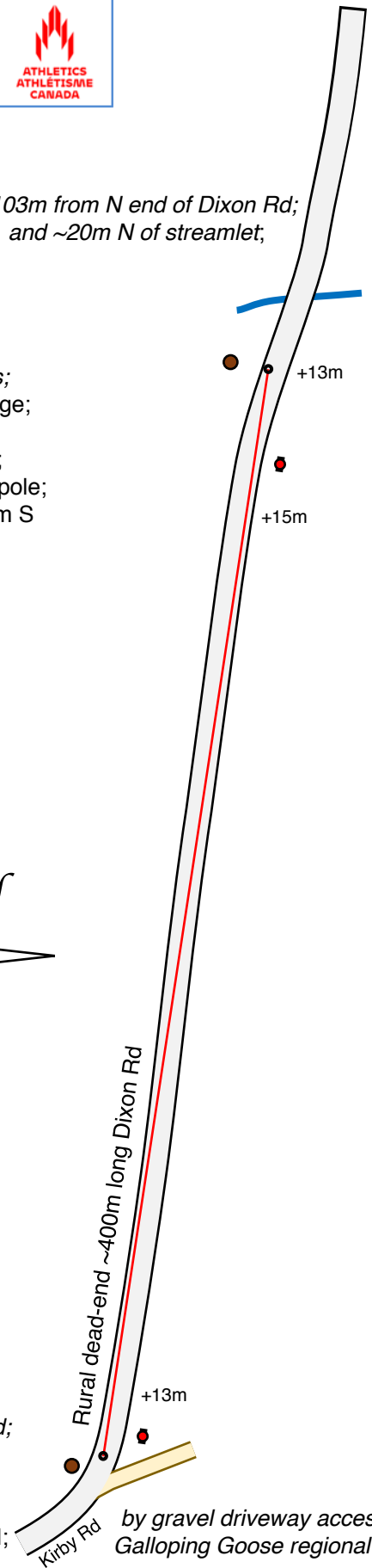

by gravel driveway access to  
Galloping Goose regional trail;