



# ATHLETICS CANADA

## ROAD RACE MEASUREMENT CERTIFICATE

### Race Information

Name of the course \_\_\_\_\_  
Certificate number \_\_\_\_\_ Distance \_\_\_\_\_ Race date \_\_\_\_\_  
City \_\_\_\_\_ Province \_\_\_\_\_  
Race contact name \_\_\_\_\_ Race contact email \_\_\_\_\_

### Course Information

Start elevation \_\_\_\_\_ Finish elevation \_\_\_\_\_  
Elevation change \_\_\_\_\_ Percent separation \_\_\_\_\_

### Measurer Information

Measurer name \_\_\_\_\_  
Measurement date \_\_\_\_\_ Expiry date \_\_\_\_\_

### Official Notice

Based on examination of data provided by the above named measurer, the course described above and in the map attached is hereby certified as reasonably accurate in measurement according to the standards adopted by the **Road Running Technical Council**. If any changes are made to the course, this certification becomes void, and the course must then be recertified.

### Validation of Course

In the event a **National Open Record** is set on this course, or at the discretion of **Athletics Canada**, a validation remeasurement may be required to be performed by a qualified measurer. If such a remeasurement shows the course to be short, then all pending records will be rejected and the course certification will be cancelled.

### As Nationally Certified by

\_\_\_\_\_  
  
Signature of certifier \_\_\_\_\_ Date \_\_\_\_\_

Any inquiries regarding this certificate should be directed to [coursemeasurement@athletics.ca](mailto:coursemeasurement@athletics.ca)





# Calgary Marathon

Athletics Canada Certified  
 AB-2019-007b-BDC  
 Certification Expires Dec 31/2028

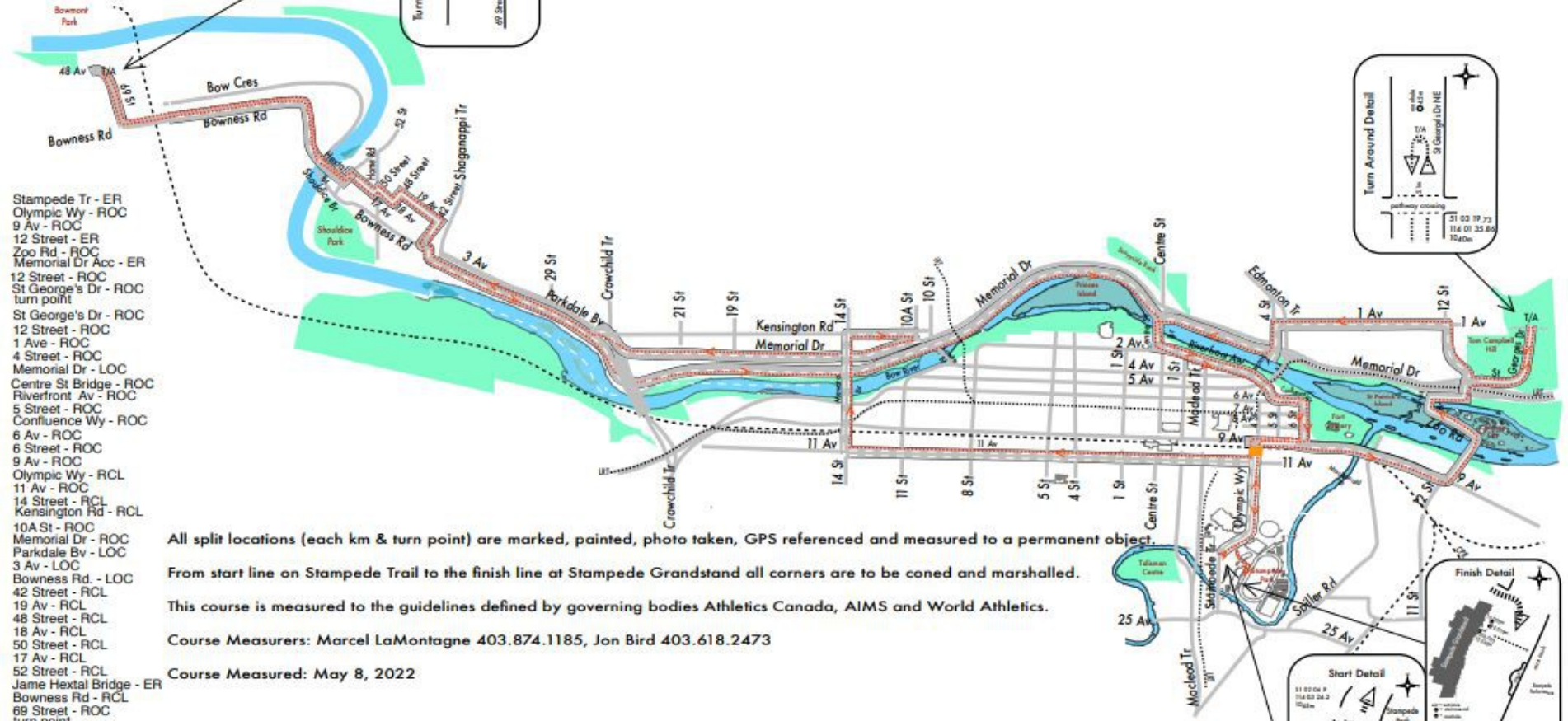

- Stampede Tr - ER
- Olympic Wy - ROC
- 9 Av - ROC
- 12 Street - ER
- Zoo Rd - ROC
- Memorial Dr Acc - ER
- 12 Street - ROC
- St George's Dr - ROC
- turn point
- St George's Dr - ROC
- 12 Street - ROC
- 1 Ave - ROC
- 4 Street - ROC
- Memorial Dr - LOC
- Centre St Bridge - ROC
- Riverfront Av - ROC
- 5 Street - ROC
- Confluence Wy - ROC
- 6 Av - ROC
- 6 Street - ROC
- 9 Av - ROC
- Olympic Wy - RCL
- 11 Av - ROC
- 14 Street - RCL
- Kensington Rd - RCL
- 10A St - ROC
- Memorial Dr - ROC
- Parkdale Bv - LOC
- 3 Av - LOC
- Bowness Rd - LOC
- 42 Street - RCL
- 19 Av - RCL
- 48 Street - RCL
- 18 Av - RCL
- 50 Street - RCL
- 17 Av - RCL
- 52 Street - RCL
- Jame Hextal Bridge - ER
- Bowness Rd - RCL
- 69 Street - ROC
- turn point
- 69 Street - ROC
- Bowness Rd - LOC
- James Hextal Bridge - ER
- 52 Street - LCL
- 17 Av - RCL
- 50 Street - RCL
- 18 Av - RCL
- 48 Street - RCL
- 19 Av - RCL
- 42 Street - RCL
- Bowness Rd - RCL
- 3 Av - RCL
- Parkdale Bv - RCL
- Memorial Dr - ROC
- Centre Street Br - LOC
- Riverfront Av - LOC
- 5 Street - LOC
- Confluence Wy - LOC
- 6 Av - LOC
- 6 Street - LCL
- 9 Av - ROC
- Olympic Wy - LCL
- Stampede Tr - LOC
- Grandstand Access - ER
- Entire Road - ER
- Right of Centre - ROC
- Right Curb Lane - RCL
- Left of Centre - LCL
- Left Curb Lane - LCL

All split locations (each km & turn point) are marked, painted, photo taken, GPS referenced and measured to a permanent object.

From start line on Stampede Trail to the finish line at Stampede Grandstand all corners are to be coned and marshalled.

This course is measured to the guidelines defined by governing bodies Athletics Canada, AIMS and World Athletics.

Course Measurers: Marcel LaMontagne 403.874.1185, Jon Bird 403.618.2473

Course Measured: May 8, 2022

start	Stampede Tr * Mid Point	Reference Course Km Points! for detailed layouts	
1 km	51 02 36.1 114 03 11.9 1038m	14km	51 02 35.5 114 05 34.1 1049m
2 km	51 02 34.79 114 02 25.07 1042m	15km	51 03 04.6 114 05 40.3 1048m
3 km	51 02 43.29 114 02 02.04 1042m	16km	51 03 03.0 114 05 27.8 1048m
4 km	51 02 53.26 114 01 44.40 1057m	17km	51 02 57.1 114 06 15.3 1051m
T/A	51 03 19.73 114 01 35.86 1041m	18km	51 03 00.9 114 07 05.8 1057m
5 km	51 03 18.89 114 01 35.98 1041m	19km	51 03 19.2 114 07 47.4 1057m
6 km	51 02 54.4 114 01 45.5 1050m	20km	51 03 36.8 114 08 30.5 1061m
7 km	51 03 11.9 114 02 18.2 1047m	21km	51 03 58.0 114 09 07.1 1061m
8 km	51 03 09.5 114 03 06.5 1044m	1/2wy	51 03 00.3 114 09 10.4 1062m
9 km	51 03 12.3 114 03 45.2 1040m	22km	51 04 22.8 114 09 32.9 1067m
10 km	51 02 56.0 114 03 05.6 1041m	23km	51 04 39.3 114 10 08.3 1066m
11 km	51 02 39.5 114 03 10.8 1041m	24km	51 05 01.4 114 10 31.3 1066m
12 km	51 02 32.0 114 03 52.2 1048m	25km	51 05 09.0 114 11 13.1 1070m
13 km	51 02 33.8 114 04 42.9 1049m	26km	51 05 41.1 114 11 41.4 1070m
		T/A	51 05 45.0 114 11 48.8 1070m
		27km	51 05 24.7 114 11 23.4 1074m
		28km	51 05 07.4 114 10 45.5 1068m
		29km	51 04 44.1 114 10 19.8 1069m
		30km	51 04 31.1 114 09 44.3 1066m
		31km	51 04 06.2 114 09 11.9 1066m
		32km	51 03 43.1 114 08 45.1 1062m
		33km	51 03 24.5 114 08 04.6 1057m
		34km	51 03 09.3 114 07 19.5 1054m
		35km	51 02 55.9 114 06 41.2 1052m
		36km	51 02 56.5 114 05 49.9 1049m
		37km	51 03 08.3 114 05 03.3 1047m
		38km	51 03 26.7 114 04 22.3 1044m
		39km	51 03 10.7 114 03 45.4 1052m
		40km	51 02 54.9 114 03 03.4 1042m
		41km	51 02 37.0 114 03 11.3 1047m
		42km	51 02 07.7 114 03 20.1 1045m
		finish	Stampede Grandstand
			51 02 02.7 114 03 16.7 1045m

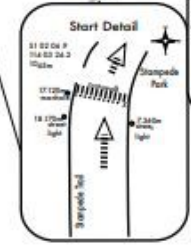
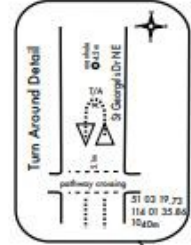
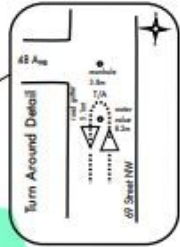



## Marathon

Start Line	51 02 06.9 114 03 24.2 1045m	Stampede Tr, south side of crosswalk to Big 4 bldg. 7.360m from street light to the south, east side, 18.170m from street light to the west, west side, 17.120m from manhole to the west, west side.
1 km	51 02 36.1 114 03 11.9 1038m	Olympic Wy SE, in tunnel linking 4 street. 7.7m from street light, in line with, centre of roadway.
2 km	51 02 34.79 114 02 25.07 1042m	9 Ave SE, in line with between #915 & 917. 0.2m from power pole, south side.
3 km	51 02 43.29 114 02 02.04 1042m	Zoo Road SE, mid point between No Parking signs, 23m from east end No Parking sign.
4 km	51 02 53.26 114 01 44.40 1057m	St George's Dr NE. 1.7m from 'No Stopping' sign south side of roadway.
turn point 4,976m	51 03 19.73 114 01 35.86 1041m	St George's Dr NE. 5.1m north of pathway crossing, 4.5m from manhole to north on roadway.
5 km	51 03 18.89 114 01 35.98 1041m	St George's Dr NE. At north entrance to Telus Spark. 1.4m from roadside gutter, 1.3m from hydro pole 38-2 83-79.
6 km	51 02 54.4 114 01 45.5 1050m	St George's Dr NE, in line with SBD path. 17.2m from street light on south side of roadway.
7 km	51 03 11.9 114 02 18.2 1047m	1 Av NE, at alley (east corner) between 9 & 9A Streets, north side. 5.4m from hydro pole to east.
8 km	51 03 09.5 114 03 06.5 1044m	4 Street NE, 2.9m from sign 'St Vladimir's Church' right arrow.
9 km	51 03 12.3 114 03 45.2 1040m	Centre St Bridge * mid point, north span, 35m south, north entrance
10 km	51 02 56.0 114 03 05.6 1041m	Riverfront Av SE, at 4 St LRT Flyover, east side. 4.3m east of traffic light post on SE corner of intersection.
11 km	51 02 39.5 114 03 10.8 1041m	9th Av SE, immediately east of 4th Street. 1.3m from fire hydrant on north side of roadway.

12 km	51 02 32.0 114 03 52.2 1048m	11th Av SW, between Centre St & 1st Street SW, in line with #110. 1.3m from Parking Plus unit.
13 km	51 02 33.8 114 04 42.9 1049m	11th Av SW, immediately east of 7th Street. 15.6m from street light at corner, west side of parking lot access.
14 km	51 02 35.5 114 05 34.1 1049m	11th Av SW, in line with #1324. 10.8m from Park Plus unit.
15 km	51 03 04.6 114 05 40.3 1048m	14th Street NW, in line with #102. At north access lane to parking lot, 1.3m from roadside gutter to north.
16 km	51 03 03.3 114 05 27.8 1048m	Memorial Dr NW, out & back section, 50m east, in line with #1224.
17 km	51 02 57.1 114 06 15.3 1051m	Memorial Dr & * 19 St NW, 60m east, in line with alley to north. 3.1m from street light.
18 km	51 03 00.9 114 07 05.8 1057m	Parkdale Bv NW & Crow Tr o/p, 75m west, 19.6m from street light to the west.
19 km	51 03 19.2 114 07 47.4 1057m	Parkdale Bv NW at 29 St, 5.2m east of crosswalk control light.
20 km	51 03 36.8 114 08 30.5 1061m	3 Av * 37 St NW, 40m west. 8.9m east of street light, 4.2m from corner post of pathway fence.
21 km	51 03 58.0 114 09 07.1 1061m	Bowness Rd at 16 Av NW overpass, west side. 8.5m west of 16 Av overpass bridge support.
half way	51 03 00.3 114 09 10.4 1062m	Bowness Rd NW, line with access road from 16th Av WBD. 3.9m from street light on south side of roadway.
22 km	51 04 22.8 114 09 32.9 1067m	46 St at 19th Av NW, in line with #4638.
23 km	51 04 39.2 114 10 08.3 1066m	17 Av * 52 St NW, 60m east, in line with #5228. 10.8m from street light on south side of roadway.
24 km	51 05 01.4 114 10 31.3 1066m	Bowness Rd NW, 100m west Mary's Store, in line with #6135. West side of driveway, 5.3m from street light.

25 km	51 05 09.9 114 11 13.1 1070m	Bowness Rd * 67th Street. 3.8m from street light on north side of roadway. In line with #6724.
26 km	51 05 41.10 114 11 41.41 1073m	69 Street, in line with #4703. 7.8m demo roadside gutter to south.
West turn point,	51 05 45.01 114 11 48.88 1072m	69 Street at 48 Av, south side. 8.2m from sewer manhole to north, 3.8m from water valve to south, 5.1m from roadway gutter, west side.
27 km	51 05 24.68 114 11 23.43 1074m	69 Street, in line with 2nd house from south. 33m from corner street light.
28 km	51 05 07.4 114 10 45.5 1068m	Bowness Rd NW, in line with #6326. 0.9m from street light.
29 km	51 04 44.1 114 10 19.8 1069m	James Hextal Br * mid pt, 6.3m from park bench.
30 km	51 04 31.1 114 09 44.3 1066m	19 Av at 48 St NW, 35m east, in line with #4832. 18.5m from street light at corner.
31 km	51 04 06.2 114 09 11.9 1066m	42 St at 19 Av NW intersection, 0.5m from gutter at corner, 11.8m from fire hydrant on east side of roadway.
32 km	51 03 43.1 114 08 45.1 1062m	3 Av at Point Dr NW west, 12m east. 10.4m from corner street light.
33 km	51 03 24.5 114 08 04.6 1057m	Parkdale Bv NW, at 32 Street, approx. 24m west. 2.3m from gutter on roadside, 2.8m from hydro pole 19-230.
34 km	51 03 09.3 114 07 19.5 1054m	Parkdale Blvd NW, at Kensington Rd. 5.3m from power pole, south side of roadway.
35 km	51 02 55.9 114 06 41.2 1052m	Memorial Dr NW, 12m east of Crowchild Tr access lane. 30.2m from street light to west, 10.5m from roadside gutter both on south side of roadway.
36 km	51 02 56.5 114 05 49.9 1049m	Memorial Dr NW at 14 Street exit ramp curbing. 10.6m from street light to east, south side of intersection.
37 km	51 03 08.3 114 05 03.3 1047m	Memorial Dr NW, 11.5m east of LRT overpass.

38 km	51 03 26.7 114 04 22.3 1044m	Memorial Dr NW at 4A Street. 17.3m from street light on centre boulevard.
39 km	51 03 10.7 114 03 45.4 1052m	Centre Street Bridge, @40m from south end. No reference points, use GPS coordinates.
40 km	51 02 54.9 114 03 03.4 1042m	Riverfront Av SW at intersection with 5 Street. 2.7m from sidewalk park bench.
41 km	51 02 37.0 114 03 11.3 1047m	Olympic Wy SE, * tunnel, mid point, 6.4m from roadside gutter.
42 km	51 02 07.7 114 03 20.1 1045m	Stampede Park parking lot, on access to Grandstand infield. 6.400m from street light to south on parking lot.
Finish	51 02 02.7 114 03 16.7 1045m	Stampede Grandstand, In line with staircase mid point into Grandstand. Signage for sections Level 1 North, 106-105, seats 105-121. 12.010m from manhole to west, 13.050m from 2 <sup>nd</sup> manhole to west.

All km points marked, painted and referenced to a permanent object.

GPS co-ordinates equate to: Latitude, Longitude, Elevation

Points 2, 3, 4, east turn point, 5 changed in 2022

Measured May 8, 2022

Marcel LAMontagne

Course Measurer, A

Athletics Canada/IAAF/AIMS

(403) 874-1185

[marcel.lamontagne@icloud.com](mailto:marcel.lamontagne@icloud.com)