



# ATHLETICS CANADA

## ROAD RACE MEASUREMENT CERTIFICATE

### Race Information

Name of the course \_\_\_\_\_  
Certificate number \_\_\_\_\_ Distance \_\_\_\_\_ Race date \_\_\_\_\_  
City \_\_\_\_\_ Province \_\_\_\_\_  
Race contact name \_\_\_\_\_ Race contact email \_\_\_\_\_

### Course Information

Start elevation \_\_\_\_\_ Finish elevation \_\_\_\_\_  
Elevation change \_\_\_\_\_ Percent separation \_\_\_\_\_

### Measurer Information

Measurer name \_\_\_\_\_  
Measurement date \_\_\_\_\_ Expiry date \_\_\_\_\_

### Official Notice

Based on examination of data provided by the above named measurer, the course described above and in the map attached is hereby certified as reasonably accurate in measurement according to the standards adopted by the **Road Running Technical Council**. If any changes are made to the course, this certification becomes void, and the course must then be recertified.

### Validation of Course

In the event a **National Open Record** is set on this course, or at the discretion of **Athletics Canada**, a validation remeasurement may be required to be performed by a qualified measurer. If such a remeasurement shows the course to be short, then all pending records will be rejected and the course certification will be cancelled.

### As Nationally Certified by

\_\_\_\_\_  
Signature of certifier

\_\_\_\_\_  
Date

**Any inquiries regarding this certificate should be directed to [coursemeasurement@athletics.ca](mailto:coursemeasurement@athletics.ca)**



# Metro Rd. N. 300 Metre Calibration Course

Measured by Peter Pimm & Sandie Orlando September 16, 2021

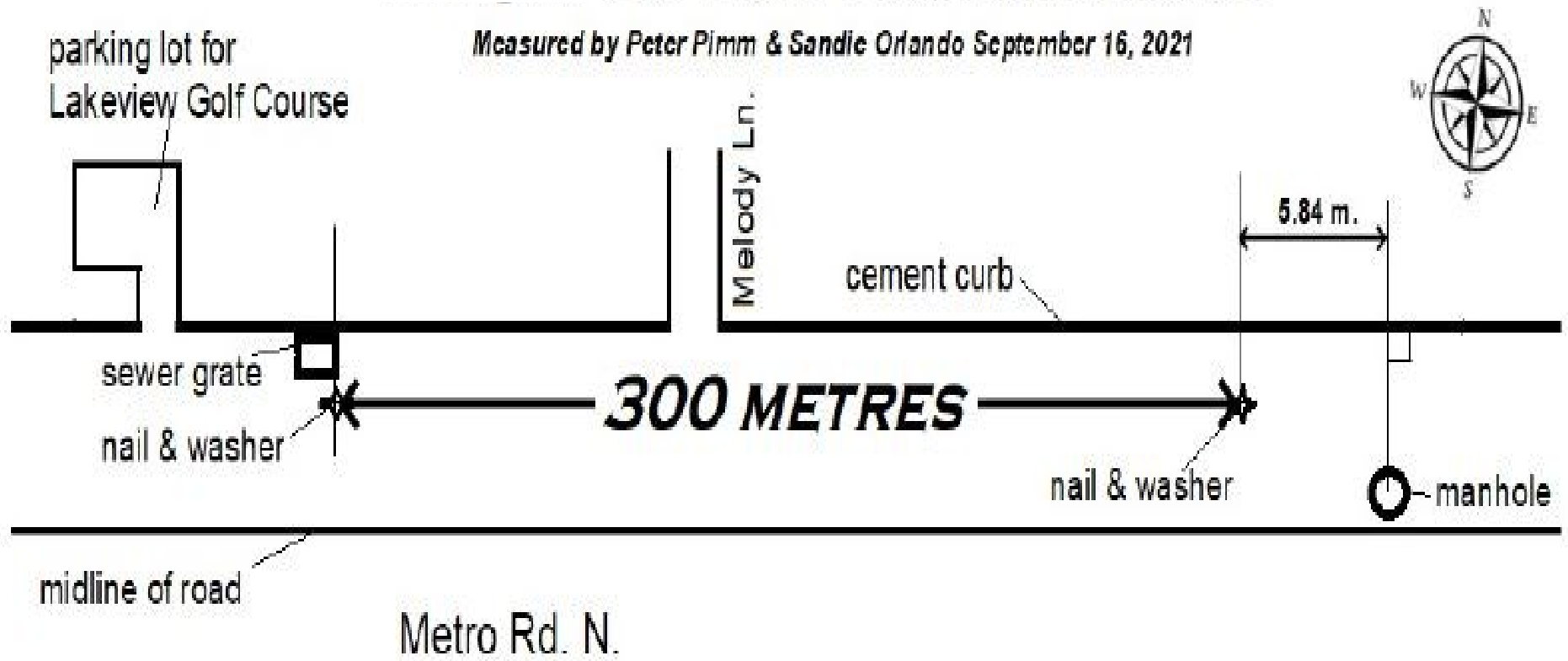

## Notes

General location - 800 metres east of De La Salle Park

West end - nail & washer in line with east edge of sewer grate

East end - nail & washer is 5.84 m. east of vertical to cement curb from centre of manhole

Nail & Washers - are located 39 inches from cement curb

Louisa St.

d/w to property  
#2087



Athletics Canada Certified  
ON-2021-018-BDC