



ATHLETICS CANADA

ROAD RACE MEASUREMENT CERTIFICATE

Race Information

Name of the course Perth Kilt Marathon
Certificate number ON-2015-023-BDC Distance 42.195 km Race date June 19/26/2016
City Perth Province ON
Race contact name Terry Stewart Race contact email perthkilrun2016@hotmail.com

Course Information

Start elevation 125 m Finish elevation 155 m
Elevation change +0.7 m/km Percent separation 38

Measurer Information

Measurer name Dave Yaeger
Measurement date July 4/2015 Expiry date Dec. 31/2025

Official Notice

Based on examination of data provided by the above named measurer, the course described above and in the map attached is hereby certified as reasonably accurate in measurement according to the standards adopted by the **Road Running Technical Council**. If any changes are made to the course, this certification becomes void, and the course must then be recertified.

Validation of Course

In the event a **National Open Record** is set on this course, or at the discretion of **Athletics Canada**, a validation remeasurement may be required to be performed by a qualified measurer. If such a remeasurement shows the course to be short, then all pending records will be rejected and the course certification will be cancelled.

As Nationally Certified by

Signature of certifier

Aug. 15, 2015
Date

Any inquires regarding this certificate should be directed to coursemeasurement@athletics.ca



PERTH KILT MARATHON

IAAF Certified

ON-2015-023-BDC

Certification Expires Dec. 31/2025

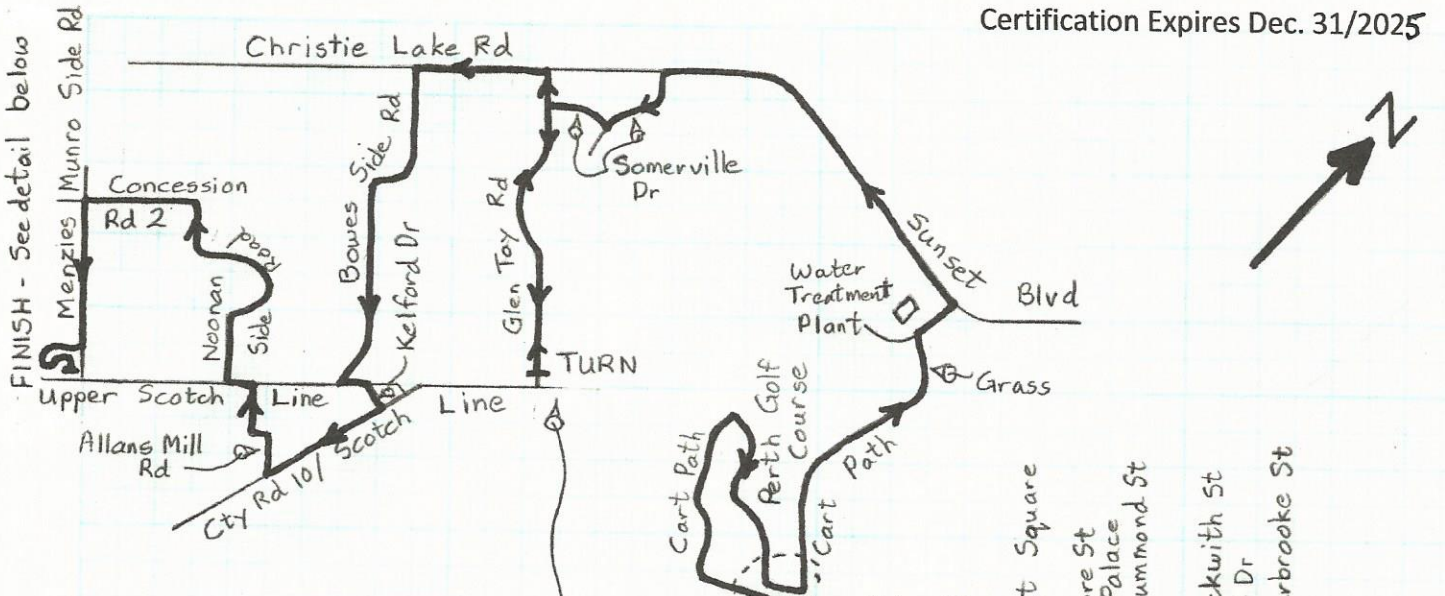

NOTES

- 1) Map Not to Scale
- 2) Runners have full use of roads except:
 - Stay to right of centreline on Rideau Ferry Road
 - Stay to left of centreline on Glen Toy Road

TURN
 In line with blue #100 sign on east side. Nail 0.2m from west edge of pavement. Place cone in middle of road.

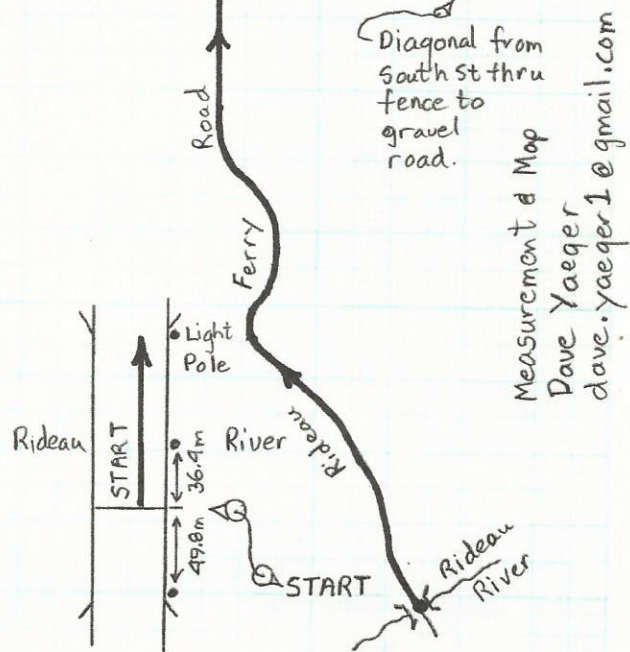
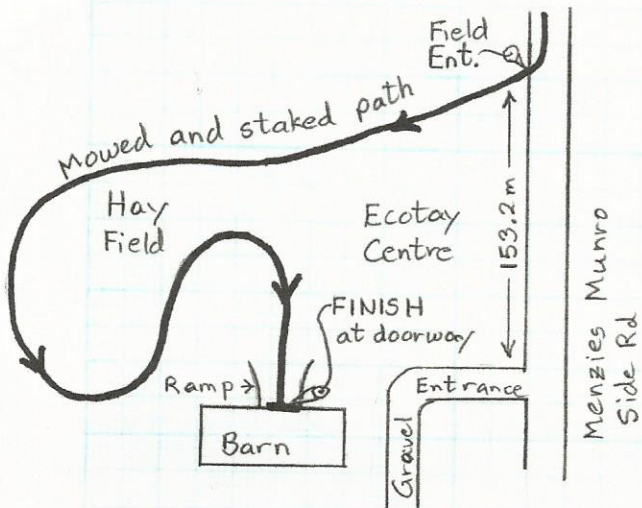
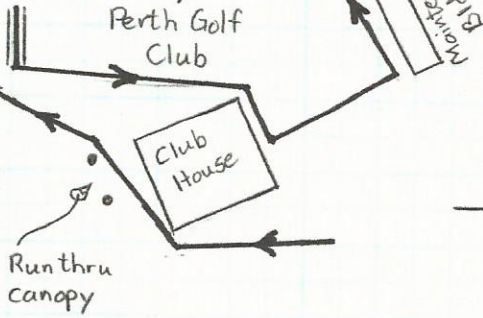

Diagonal from South St thru fence to gravel road.
 Measurement & Map
 Dave Yaeger
 dave.yaeger1@gmail.com