



# ATHLETICS CANADA

## ROAD RACE MEASUREMENT CERTIFICATE

### Race Information

Name of the course Waterloo Classic 10 km  
Certificate number ON-2015-015-BDC Distance 10 km Race date June 21/2015  
City Kitchener Province Ontario  
Race contact name Lloyd Schmidt Race contact email lloyd@runwaterloo.com

### Course Information

Start elevation 372 m Finish elevation 370 m  
Elevation change -0.2 m/km Percent separation 3

### Measurer Information

Measurer name Lloyd Schmidt  
Measurement date June 6/2015 Expiry date Dec. 31/2024

### Official Notice

Based on examination of data provided by the above named measurer, the course described above and in the map attached is hereby certified as reasonably accurate in measurement according to the standards adopted by the **Road Running Technical Council**. If any changes are made to the course, this certification becomes void, and the course must then be recertified.

### Validation of Course

In the event a **National Open Record** is set on this course, or at the discretion of **Athletics Canada**, a validation remeasurement may be required to be performed by a qualified measurer. If such a remeasurement shows the course to be short, then all pending records will be rejected and the course certification will be cancelled.

### As Nationally Certified by

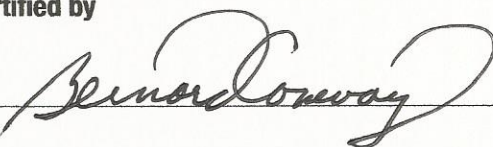
Signature of certifier 

June 19, 2015  
Date

Any inquiries regarding this certificate should be directed to [coursemeasurement@athletics.ca](mailto:coursemeasurement@athletics.ca)



**Waterloo Classic 10 KM**

Resurrection Catholic Secondary School  
455 University Ave W, Kitchener, ON

**Course Description:**

Start on Resurrection Dr

Left onto University Avenue W

Right onto Ira Needles Blvd (onto sidewalk)

Right onto Thorndale Dr

Right onto Fischer-Hallman Rd N (move onto sidewalk at Glasgow St)

Right onto Victoria St S

Right onto Ira Needles Blvd (onto sidewalk)

Right onto University Ave W

Right onto Resurrection Dr

Left into Parking Lot to Finish on the track

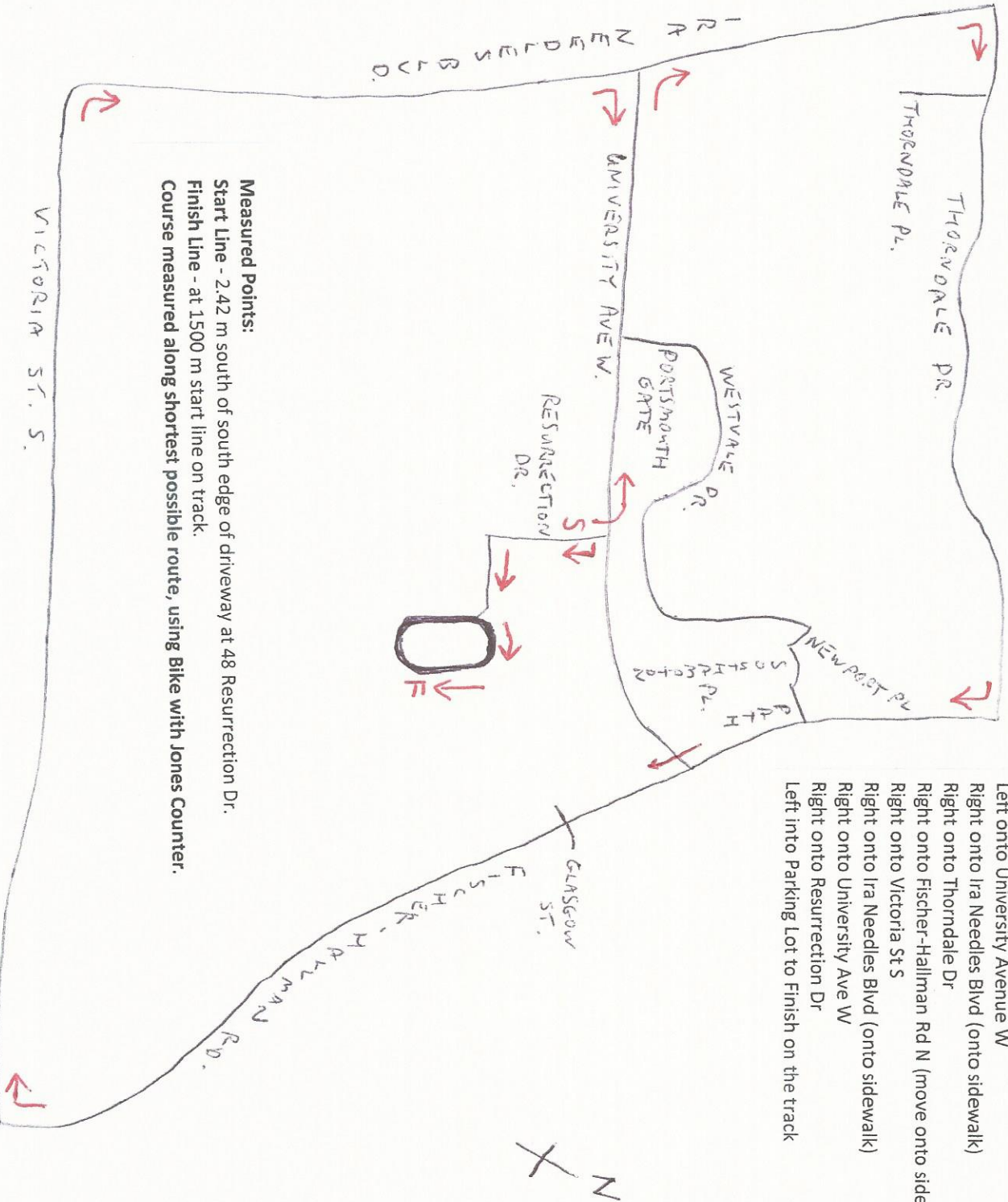

**Measured Points:**

Start Line - 2.42 m south of south edge of driveway at 48 Resurrection Dr.

Finish Line - at 1500 m start line on track.

Course measured along shortest possible route, using Bike with Jones Counter.