



Notice to Race Director
Use this Certification Code in *all* public
announcements relating to your race.

Validation of Course — In the event a National Open Record is set on this course, or at the discretion of Athletics Canada/Run Canada, a validation remeasurement may be required to be performed by a qualified measurer. If such a remeasurement shows the course to be short, then all pending records will be rejected and the course certification will be cancelled.

This certification expires on December 31 in the year 2021

AS NATIONALLY CERTIFIED BY:

Phone: 519-641-6889 (H) Fax: 519-641-6889 E-mail: measurer@rogers.com

Twenty Valley Run, Wine, Dine Half Marathon

Start - 81.9 m west of the west entrance/exit to Charles Daly Park

- 1 km - 63 m south of Lakeshore Rd W on Gregory St. N
- 2 km - 10 m east of mailboxes for 1361 Lakeshore Rd. W, 22 m west of barn in vineyard
- 3 km - 22 m north of driveway of 1361 5th Louth St.
- 4 km - in line with the 65th post of vineyard counting from the west
- 5 km - 12 m east of east end of greenhouse, 4 m east of east side of bunk-house
- 6 km - 9 m west of driveway of 1583 Second Ave. Louth
- 7 km - 1 m east of 33rd row of peach trees counting from Gregory St. S on Second Ave. Louth
- 8 km - 126 m north of bridge on Glass St. on north side of valley
- 9 km - 9 m west of sign for 1983 Glass Ave.
- 10 km - 61 m south of sign for 4205 Eleventh Louth St.
- 11 km - 24 m west of post (1159441), 3rd post west of 9th Ave. Louth on Glass Ave.

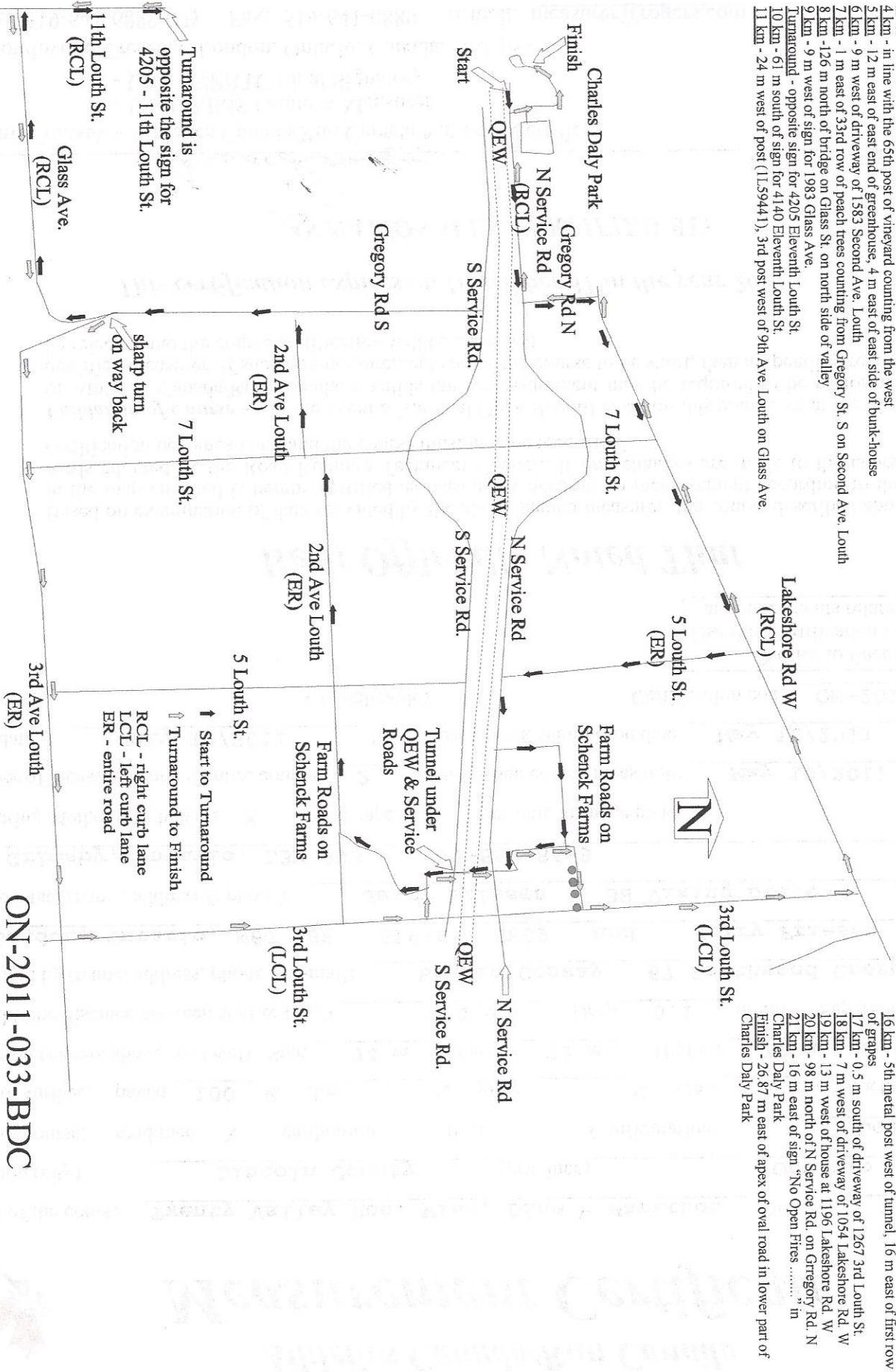

ON-2011-033-BDC