



# Athletics Canada/Run Canada Measurement Certificate

Name of the course Teron Road 319.606 m Cal. Course Distance 319.606 m  
Location (city) Ottawa (province) Ontario  
Type of course: road race calibration ☒ track Configuration: Point to Point  
Type of surface: paved ☒ dirt \_\_\_\_\_ gravel \_\_\_\_\_ grass \_\_\_\_\_ track \_\_\_\_\_  
Elevation (meters above sea level) 89 m  
Straight line distance between start & finish 319.606 m Drop 0 m/km Separation 100 %  
Measured by (name, address, phone & e-mail) John Halvorsen 37 Pentland Crescent  
Kanata, ON and Joe Du Vall  
Contact (name, address & phone) \_\_\_\_\_  
Measuring Methods: steel tape ☒ electronic distance meter  
Number of measurements of entire course: two Date(s) when course measured: June 20, 2009  
Course paperwork submission date: June 29, 2009  
Replaces: \_\_\_\_\_ (if applicable) Certification code: \_\_\_\_\_

ON-2009-080-BDC

## Be It Officially Noted That

Based on examination of data provided by the above named measurer, the course described above and in the map attached is hereby certified as reasonably accurate in measurement according to the standards adopted by the Road Running Technical Council. If *any* changes are made to the course, this certification becomes void, and the course must then be recertified.

**Validation of Course** — In the event a National Open Record is set on this course, or at the discretion of Athletics Canada/Run Canada, a validation remeasurement may be required to be performed by a qualified measurer. If such a remeasurement shows the course to be short, then all pending records will be rejected and the course certification will be cancelled.

AS NATIONALLY CERTIFIED BY:

Bernard Conway  
Bernard Conway - Athletics Canada/Run Canada National Certifier  
- IAAF/AIMS Grade A Measurer  
- USATF/RRTC Final Signatory

Date: June 30, 2009

67 Southwood Crescent, London, Ontario, Canada, N6J 1S8  
Phone: 519-641-6889 (H) Fax: 519-641-6889 E-mail: [measurer@rogers.com](mailto:measurer@rogers.com)

CALIBRATION COURSE IS LOCATED ON THE  
EAST SIDE (NORTH BOUND) LANE SIDE (INSIDE BIKE LANE)

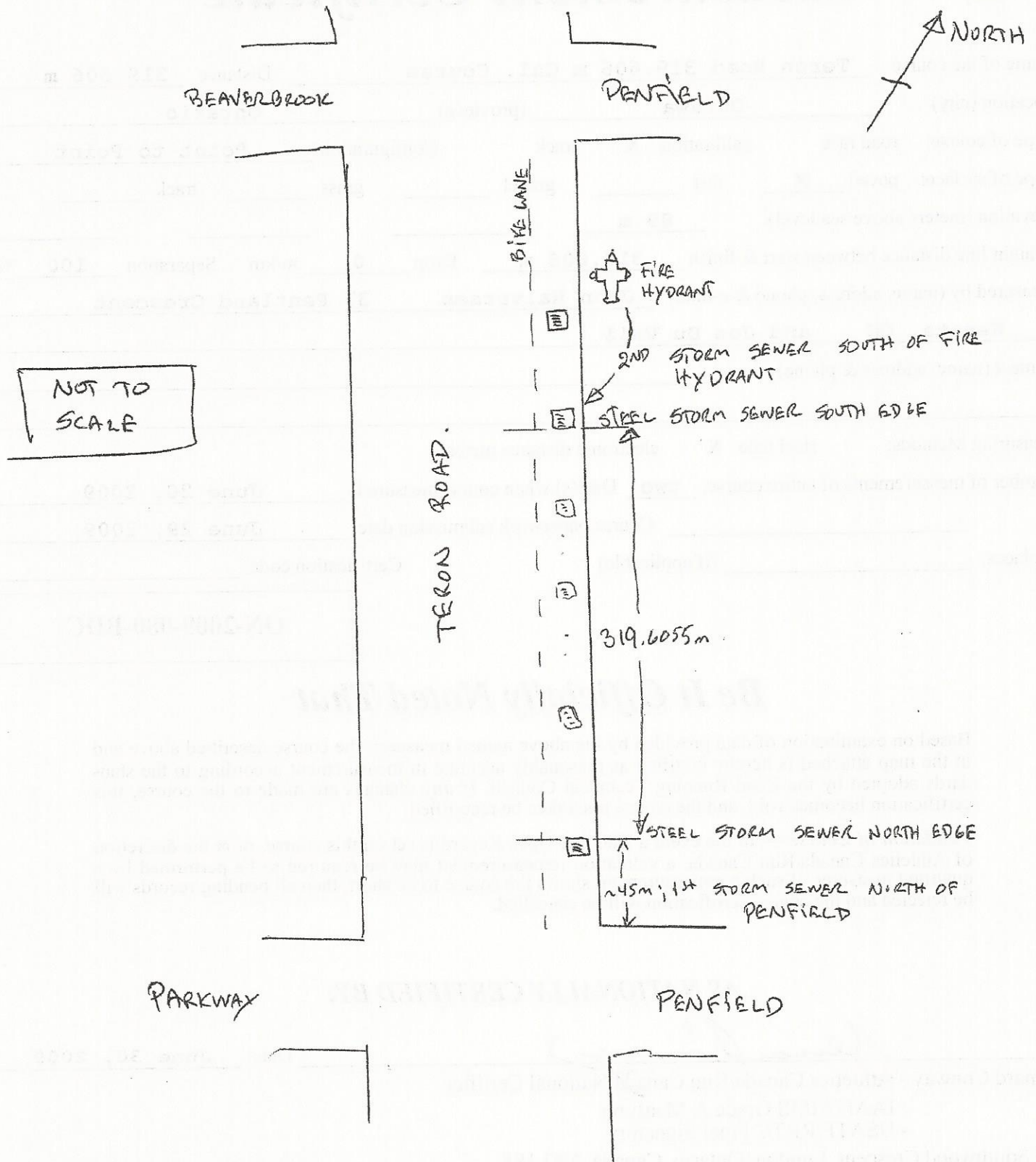

ON-2009-080-BDC