



# ATHLETICS CANADA

## ROAD RACE MEASUREMENT CERTIFICATE

### Race Information

Name of the course Fiddlers Half Marathon

Certificate number NS-2016-089-BDC Distance 21.0975 km Race date Sept. 11/2016

City Sydney Province NS

Race contact name Jeris Abbass Race contact email jerisabbass@gmail.com

### Course Information

Start elevation 7.8 m Finish elevation 7.8 m

Elevation change 0 m/km Percent separation 6.6

### Measurer Information

Measurer name Jerris Abbass jerisabbass@gmail.com 902-322-0230

Measurement date July 14/2016 Expiry date Dec. 31/2025

## Official Notice

Based on examination of data provided by the above named measurer, the course described above and in the map attached is hereby certified as reasonably accurate in measurement according to the standards adopted by the **Road Running Technical Council**. If any changes are made to the course, this certification becomes void, and the course must then be recertified.

### Validation of Course

In the event a **National Open Record** is set on this course, or at the discretion of **Athletics Canada**, a validation remeasurement may be required to be performed by a qualified measurer. If such a remeasurement shows the course to be short, then all pending records will be rejected and the course certification will be cancelled.

### As Nationally Certified by

 Aug. 10/2016  
Signature of certifier Date

Any inquires regarding this certificate should be directed to [coursemeasurement@athletics.ca](mailto:coursemeasurement@athletics.ca)



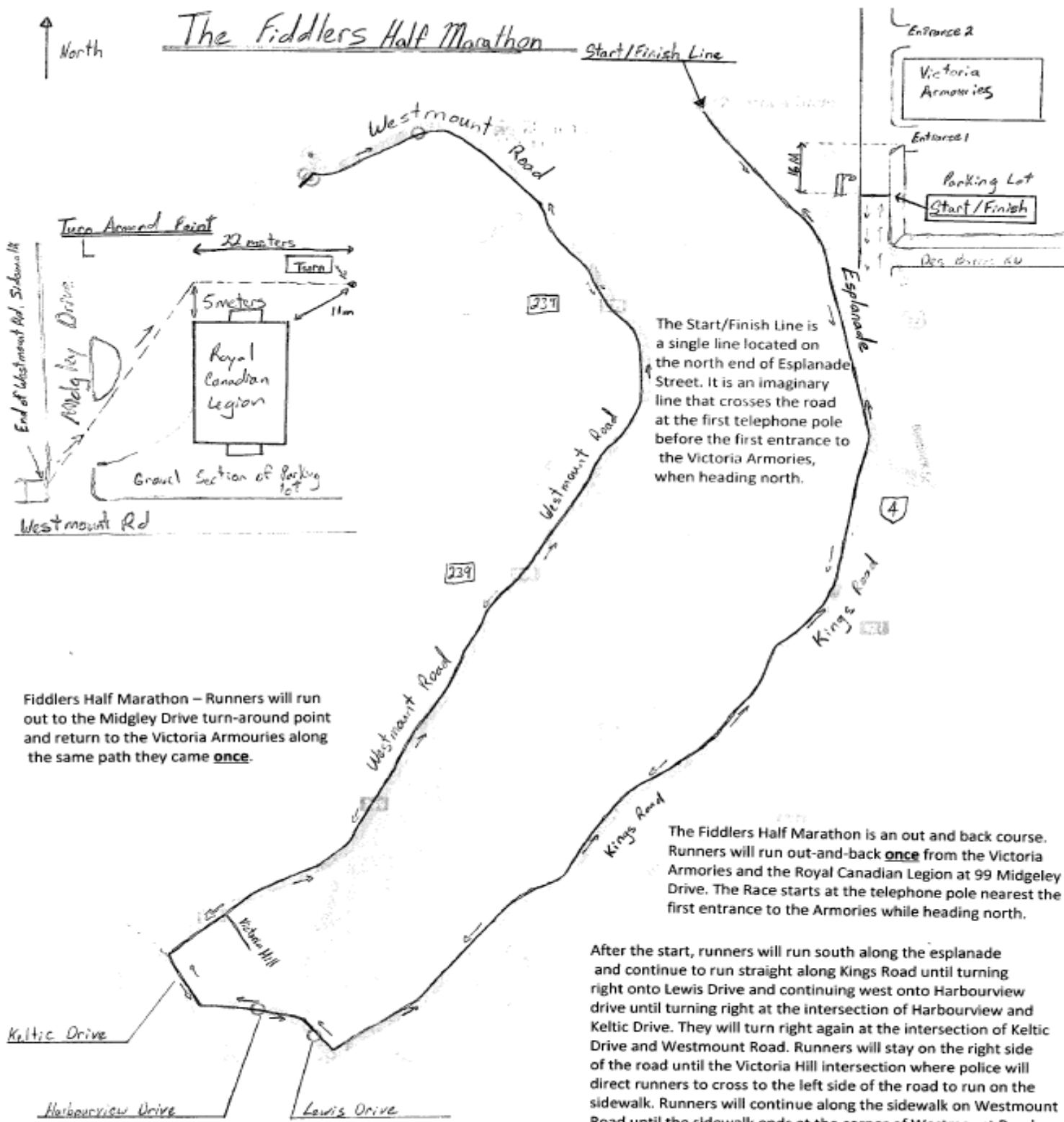

# The Fiddlers Half Marathon

Start/Finish Line

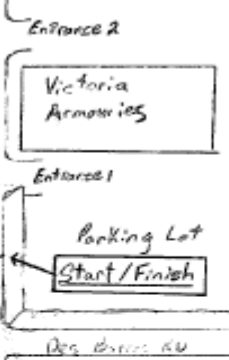

The Start/Finish Line is a single line located on the north end of Esplanade Street. It is an imaginary line that crosses the road at the first telephone pole before the first entrance to the Victoria Armouries, when heading north.

Fiddlers Half Marathon – Runners will run out to the Midgeley Drive turn-around point and return to the Victoria Armouries along the same path they came **once**.

The Fiddlers Half Marathon is an out and back course. Runners will run out-and-back **once** from the Victoria Armouries and the Royal Canadian Legion at 99 Midgeley Drive. The Race starts at the telephone pole nearest the first entrance to the Armouries while heading north.

After the start, runners will run south along the esplanade and continue to run straight along Kings Road until turning right onto Lewis Drive and continuing west onto Harbourview drive until turning right at the intersection of Harbourview and Keltic Drive. They will turn right again at the intersection of Keltic Drive and Westmount Road. Runners will stay on the right side of the road until the Victoria Hill intersection where police will direct runners to cross to the left side of the road to run on the sidewalk. Runners will continue along the sidewalk on Westmount Road until the sidewalk ends at the corner of Westmount Road and Midgeley Drive. Runners will turn left onto Midgeley drive and then immediately turn right into the Legion parking lot where they will turn around and return to the Victoria Armouries along the same route, and the same side of the road, as they came.

Athletics Canada Certified  
 NS-2016-089-BDC  
 Certification Expires Dec. 31/2025

