



ATHLETICS CANADA

ROAD RACE MEASUREMENT CERTIFICATE

Race Information

Name of the course Hwy 332 Bayport Calibration Course
Certificate number NS-2016-016-BDC Distance 300 m Race date _____
City Bayport Province NS
Race contact name _____ Race contact email _____

Course Information

Start elevation _____ Finish elevation _____
Elevation change 0 m/km Percent separation 100

Measurer Information

Measurer name Perry Abriel & Christopher Anderson
Measurement date March 30/2016 Expiry date _____

Official Notice

Based on examination of data provided by the above named measurer, the course described above and in the map attached is hereby certified as reasonably accurate in measurement according to the standards adopted by the **Road Running Technical Council**. If any changes are made to the course, this certification becomes void, and the course must then be recertified.

Validation of Course

In the event a **National Open Record** is set on this course, or at the discretion of **Athletics Canada**, a validation remeasurement may be required to be performed by a qualified measurer. If such a remeasurement shows the course to be short, then all pending records will be rejected and the course certification will be cancelled.

As Nationally Certified by

Bernard Conway
Signature of certifier

April 15/2016

Date

Any inquires regarding this certificate should be directed to coursemeasurement@athletics.ca



BAYPORT NOVA SCOTIA

Athletics Canada Certified
NS-2016-016-BDC

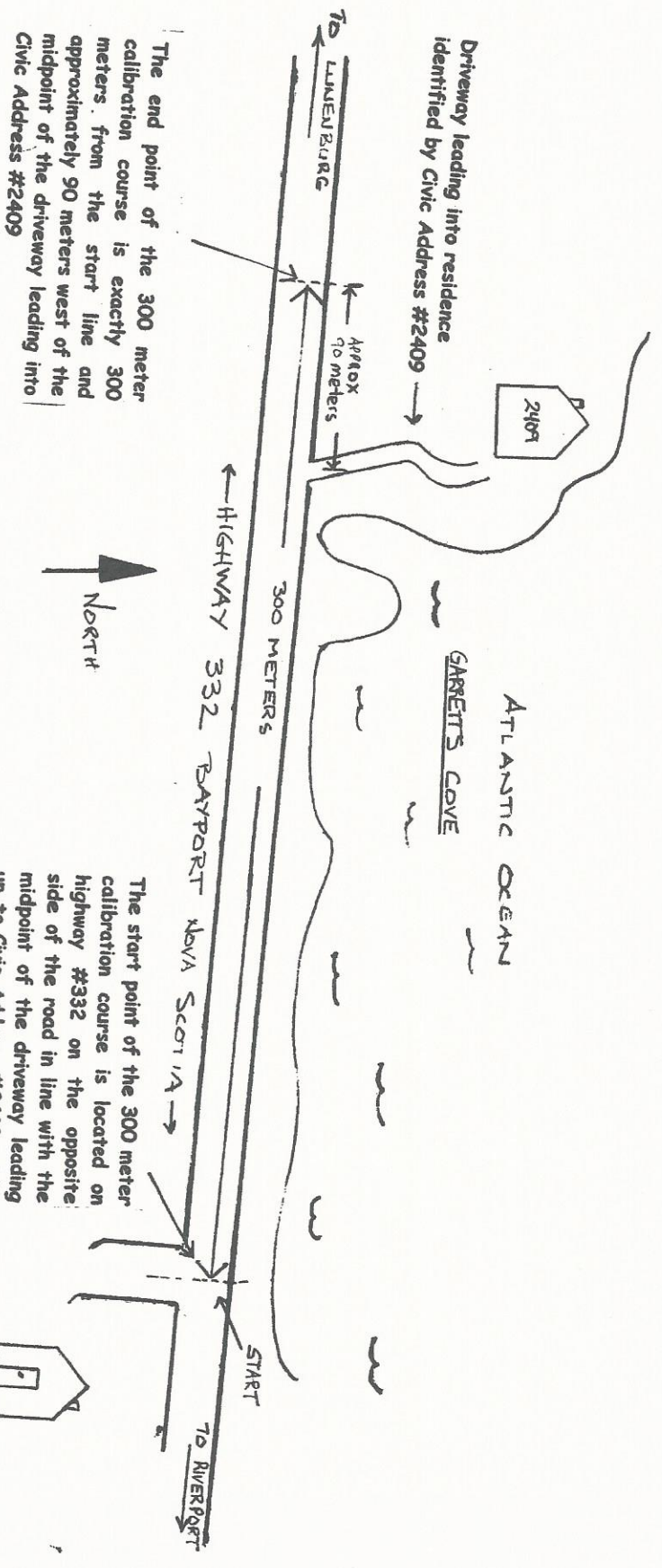

The end point of the 300 meter calibration course is exactly 300 meters from the start line and approximately 90 meters west of the midpoint of the driveway leading into Civic Address #2409

The start point of the 300 meter calibration course is located on highway #332 on the opposite side of the road in line with the midpoint of the driveway leading up to Civic Address #2462. The start point is marked with 3 PK nails and orange spray paint.

The 300 meter bicycle calibration course is located on Nova Scotia Highway 332 in Bayport, Lunenburg County. It is located on the north side of the highway approximately 0.35 meters from the edge of the pavement. The start of the calibration course is on the opposite side of the highway (north side) directly across the road from midpoint of the driveway leading up to Civic Address 2462. Each of the endpoints are marked with 3 PK nails and orange spray paint

300 METER BAYPORT NOVA SCOTIA HIGHWAY 332 CALIBRATION COURSE